

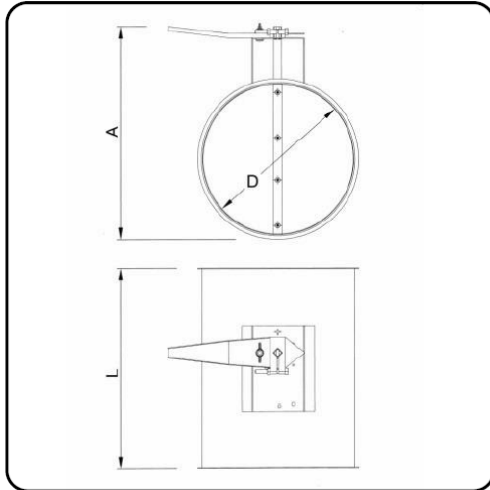

## Throttle Valves

Code TV



Picture and handle orientation may differ from product and is subject to change

### Material

galvanised steel with double plate damper

### Sizes

80mm to 500mm

### Operation

Manually operated, with continuously variable opening settings. 96% maximum closure.

### Options

Can be fitted with electric operation as an optional accessory. Please ask us for specifications

Dimensional specifications are given in the table below

### Dimensional Specifications

PRODUCT CODE	Inside diameter	Housing thickness	Gate thickness	Overall length	Weight kg
	D mm	S mm	mm	L mm	
TV80	80	0.75	1.8	200	0.91
TV100	100	0.75	1.8	200	1.12
TV125	125	0.75	1.8	205	1.31
TV140	140	0.75	1.8	220	1.48
TV150	150	0.75	1.8	230	1.59
TV160	160	0.75	1.8	240	1.71
TV180	180	0.75	1.8	260	1.98
TV200	200	0.75	1.8	280	2.31
TV225	225	0.75	1.8	305	2.71
TV250	250	0.75	1.8	330	3.15
TV275	275	0.75	1.8	355	3.62
TV300	300	0.75	1.8	380	4.14
TV315	315	0.75	1.8	395	4.47
TV350	350	0.9	1.8	430	5.30
TV400	400	0.9	1.8	480	7.59
TV450	450	0.9	1.8	530	9.30
TV500	500	0.9	1.8	580	11.20

All product design specifications are subject to change without notice. Images are for illustration purposes only

